

DIGITAL RTJ RING GROOVE CALIPER

DATA
OUTPUT

- Measure ring grooves of flange
- Resolution: 0.01mm/0.0005"
- Button function: on/off, set, zero, mm/inch, data preset
- Battery CR2032
- Data output
- Made of stainless steel
- Optional accessory: data output cable (code 7306-20, 7302-SPC5A/SPC5B, 7305-SPC2A)



1179-300

preset buttons

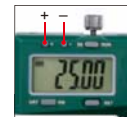

1179-600

measure outside diameter
of RTJ ring groove

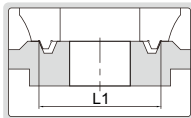

measure inside diameter
of RTJ ring groove

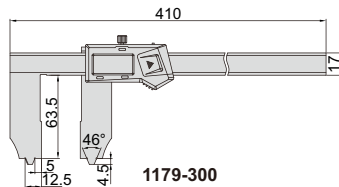
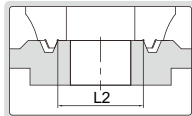

1179-300

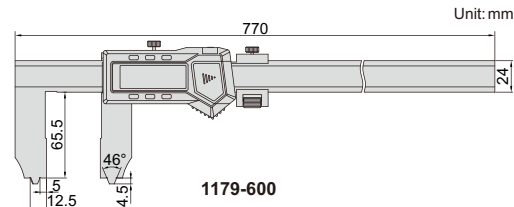

1179-600

Unit: mm

applicable for RTJ ring
grooves with angle 23°

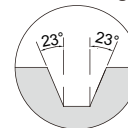

Code	Range (inside diameter of RTJ ring groove)	Range (outside diameter of RTJ ring groove)	Angle of RTJ ring groove	Accuracy
1179-300	10-300mm/0.4-12"	25-300mm/1-12"	23°	±0.06mm
1179-600	10-600mm/0.4-24"	25-600mm/1-24"	23°	±0.07mm